



**Engineering Food Services**

[www.continentalindia.com](http://www.continentalindia.com)



## Overview

Continental Equipment, started in 1978, is India's largest commercial food service equipment manufacturer and supplier.

Working with key customers and clients, Continental designed and developed foodservice solutions to cater to the requirements of the fast emerging foodservice industry in the country.

The company has since then thrived on the idea of improved designs, production facilities and customer service and it is because of these efforts that it can today pride itself on being the largest company supplying food service, bakery and beverage equipment to hotels, bakeries, coffee chains and restaurants in India.

In its endeavor to become a supply chain partner for leading food service organizations globally, the organization has set up operations all over the country and has also been involved in providing solutions to organizations in the USA, Middle East, Europe, Asia & Asia Pacific markets.

Continental is focused in the areas of Project and Key Accounts Management.

The projects executed in India and abroad, range from 4 & 5 star hotels to canteens, schools, ashrams, hospitals, specialty restaurants etc. While there is an exclusive team working on project execution, Continental can provide complete solution with fabricated, Refrigerated, Imported equipment and also COLD ROOMS.

Continental is approved supplier to McDonalds, KFC, Pizza Hut, Papa Johns, Sbarro, Yo China, Nirula's, Barista, Café coffee day, Costa and many other International and Indian QSRs. Continental provides them services in Equipment Design, Equipment fabrication, Imported and Indian equipment Distribution, Installation, Warranty, Service etc.

Continental also exports its products to the markets in Europe for which it has all the necessary certifications. It is a regular exporter to UK for some specialized items.

Continental also boasts of the largest network of service in the country with service centers in 14 different cities.



National Awards  
to Small Scale Entrepreneurs 2003



Best Supplier Award, 2002  
by McDonalds



Best Supplier Award, 2004  
by McDonalds



Partner Supplier  
Award 2010  
by YUM



Best Kitchen  
Equipment  
Supplier, 2011



## Overseas Partners





## Key Partners





## Ovens

### ContiBake Baking Oven - Large

Model No.	Dimensions	Capacity	Power (KW)	Energy
COL/E-23	1600 x 1120 x 460	In Trays: 4	9	Electricity
COL/E-16	1600 x 1120 x 395	In Trays: 4	6.5	Electricity
COL/G-17	1600 x 1120 x 550	In Trays: 4	LPG	Gas

### ContiBake Baking Oven - Medium

Model No.	Dimensions	Capacity	Power (KW)	Energy
COM/E-23	1400 x 1120 x 460	In Trays: 3	6	Electricity
COM/E-16	1400 x 1120 x 395	In Trays: 3	4.5	Electricity
COM/G-17	1400 x 1120 x 550	In Trays: 3	LPG	Gas

### ContiBake Baking Oven - Small

Model No.	Dimensions	Capacity	Power (KW)	Energy
COS/E-23	1400 x 875 x 460	In Trays: 2	4.5	Electricity
COS/E-16	1400 x 875 x 395	In Trays: 2	3	Electricity
COS/G-17	1400 x 875 x 550	In Trays: 2	LPG	Gas

### ContiBake Baking Oven - Mini

Model No.	Dimensions	Capacity	Power (KW)	Energy
CON/E-23	815 x 760 x 460	In Trays: 1	3.75	Electricity
CON/G-17	815 x 760 x 550	In Trays: 1	LPG	Gas

## Veggie Washer

### The CONTINENTAL Veggie Washer incorporates

- Washing Pan, nozzles all made of Stainless Steel 304.
- Water Vessel with necessary plumbing connections, in Stainless Steel 304.
- The unit is mounted on stainless steel legs with vibration free pads
- Hydraulic Tilting System for unloading of product is operable with a push of button on the panel
- Pumps are provided in the enclosure
- Veggie Washer is available in 4 models to meet small and large requirements.

### Veggie Washer

Products	Model No.	Dimensions	Capacity	Power (KW)	Energy
Manual Type	CVW-15	600 x 555 x 950	Per Charge in Kg: 15	0.75 HP	Electricity
Manual Type	CVW-30	1035 x 555 x 950	Per Charge in Kg: 30	1 HP	Electricity
Tilting Type	CVW-50	1800 x 850 x 1025	Per Charge in Kg: 50	3 HP	Electricity
Tilting Type	CVW-90	1700 x 1340 x 1150	Per Charge in Kg: 90	3 HP	Electricity



Model CVW - 15

Model CVW - 30







## Counter Top Range

### Toasters

Products	Model No.	Dimensions	Capacity	Power (KW)	Energy
Conveyor Toaster		465 x 415 x 405	500 PCS/HR	2.5	Electricity
Toaster Quartz	CTOS-Q	455 x 255 x 260	6 Slices	3	Electricity

### Deep Fat Fryers

Products	Model No.	Dimensions	Capacity	Power (KW)	Energy
Mini Master Fryer	CMF-6/I/E	190 x 435 x 310	4-6 Litrs	2	Electricity
Mini Master Fryer	CMF-6/II/E	400 x 435 x 310	6 Litr Eatc	4	Electricity
Portable Fryer	CPF-9/I/E	280 x 460 x 310	9 Litr	3	Electricity
Portable Fryer	CPF-9/II/E	580 x 460 x 310	9 Litr Each	6	Electricity

### Fry Dump

Products	Model No.	Dimensions	Capacity	Power (KW)	Energy
French Fry Dump	CFF-D/P	450 x 460 x 310	Portable	NA	NA

### Grillers

Products	Model No.	Dimensions	Power (KW)	Energy
Contact Griller	CG-C1	260 x 375 x 190	1.55	Electricity
Contact Griller	CG-CII	520 x 375 x 190	3.1	Electricity
Contact Griller	CG-LS	370 x 360 x 200	2.25	Electricity
Contact Griller	CG-LD	720 x 360 x 200	4.5	Electricity
Crepe Maker	CM-C1	260 x 375 x 190	1.55	Electricity
Wrap Griller	WG- C1	260 x 375 x 190	1.55	Electricity

### Waffle Machine

Products	Model No.	Dimensions	Power (KW)	Energy
Waffle Baker	WB-C1	260 x 400 x 240	1.55	Electricity
Waffle Cone Maker	WC-C1	260 x 400 x 240	1.55	Electricity





*Phulka Chef*



## Special Products

The Ultimate in Chapati Cooking

Energy Efficient - Very Low Gas Consumption - 1.25 Kg/hr

Easy to Operate

Labour Saving - Only One Operator

Space Saving - Floor Area 1.5Sq. Mtr.

Gas Chapati Machine - Rolls - Cooks - Puffs

Incorporates - Rolling Section - Cooking & Puffing Section -

Revolving Steel Plate Tawas - Delivery Conveyor - All in Compact Shape

Stainless Steel Construction - with Hinged Glass Doors - Full view of Operation

Mounted on heavy - duty Stainless Steel Legs with Stainless Steel Bullet Feet

We develop specialized products for many companies all over the globe. One such example is a kiosk made for a client in UK,.

The product is called Filling station and is shown below : **Filling Station**

*Potato Peeler*

The drum storage capacity is 10 kg. potatoes.

Voltage : 220V, Power Rating : 0.5 HP,

Height : 955 mm, Lid Dia. : 520 mm

Production : 100 Kg/h.



*Filling Station*





## Beverages

### Instant Hot Beverage Premixes

Continental India brings to the vending world a welcome innovation enabling vending operators to expand the portfolio and enhance the attractiveness of the offered drinks and coffee specialties, which is a precondition for satisfying customer's increasing demands.

Hygienically manufactured in Europe by AGFOODS, the blends conform to the highest standards while offering an authentic flavor.

Our versatile range of Instant premix powders allows you to choose a variety of cappuccinos, soups, hot chocolates and teas,



## Beverages Equipment



Coffee Machines



Coffee Brewers



### Promote your Juice brand using the Bunn JDF-2S.

The Bunn JDF-2S 2 flavor cold beverage juice dispenser with a lit door from Bunn's renowned Silver Series is. This juice dispenser includes two 1 gallon containers that hold concentrate and can be set to pump and mix concentrated beverages with up to an 11:1 ratio of water-to-concentrate. It features Bunn's patented High Intensity mixing technology to ensure reliable drink consistency, while its quick dispense system dispenses beverages at up to 1.5 oz. per second, or four 5 oz. drinks per minute.



Juicers





**FROSTLINE**

PRODUCT OF CONTINENTAL



## Refrigerators

Frostline, a brand owned by Continental Group, brings to you International Quality Refrigerators using International Technology but Indian engineering to suit harsh conditions.

Frostline's plant, having automated European machines, produces vast range of products which are sold and installed all over India and various parts of the world including the Gulf, Africa and Asia.

### CABINETS

Model No.	°C	Lt	Watt	WxDxH cm	Ambient Temp.
RC5	-2° +8°	485	270	72x70x212	+43
RF5	-10° -20°	485	670	72x70x212	+43
RC7 / RC7-2	-2° +8°	700	277	72x80x212	+43
RF7 / RF7-2	-10° -20°	700	681	72x80x212	+43
RC10	-2° +8°	1066	340	144x70x212	+43
RF10	-10° -20°	1066	1000	144x70x212	+43
RC14/RC14-4	-2° +8°	1400	346	144x80x212	+43
RF14/RF14-4	-10° -20°	1400	1082	144x80x212	+43

### COUNTERS

Model No.	°C	Lt	Watt	WxDxH cm	Ambient Temp.
UC2	-2° +8°	275	298	131x70x85	+43
UC3	-2° +8°	428	372	177,5x70x85	+43
UC4	-2° +8°	581	418	224x70x85	+43
UF2	-10° -20°	275	565	131x70x85	+43
UF3	-10° -20°	428	708	177,5x70x85	+43
UF4	-10° -20°	581	752	224x70x85	+43

### SANDWICH / PIZZA TABLE

Model No.	°C	Lt	Watt	WxDxH cm	Ambient Temp.
PTS2-3D	-2° +8°	350	253	164x71x85+35	+43
UC2SW	+2 +10°	236	321	131x70x101	+43
UC3SW	+2 +10°	367	372	177.5x70x101	+43



Engineering Food Services



## Ice Cuber



## Dishwasher



## Food Processing Machines





## Project Management



For the last 30 years or so, Continental has been instrumental in executing some of the biggest projects in India. These include Tata Steel, ISB, Maruti, Akshardham, Taj Flight Catering, Intercontinental Hotels, Novotel Hyderabad, ITDC – Ashok, Oberoi towers and many other 5, 4 and 3 star hotels and restaurant etc.

Once again Continental provides complete solution in this regards. It takes up kitchen planning to installation for any size of the project. It has a strong team of engineers in the execution department along with exclusive project sales support staff all over the country.

Continental has also executed projects in the Middle east Asia, Maldives, Russia, London etc

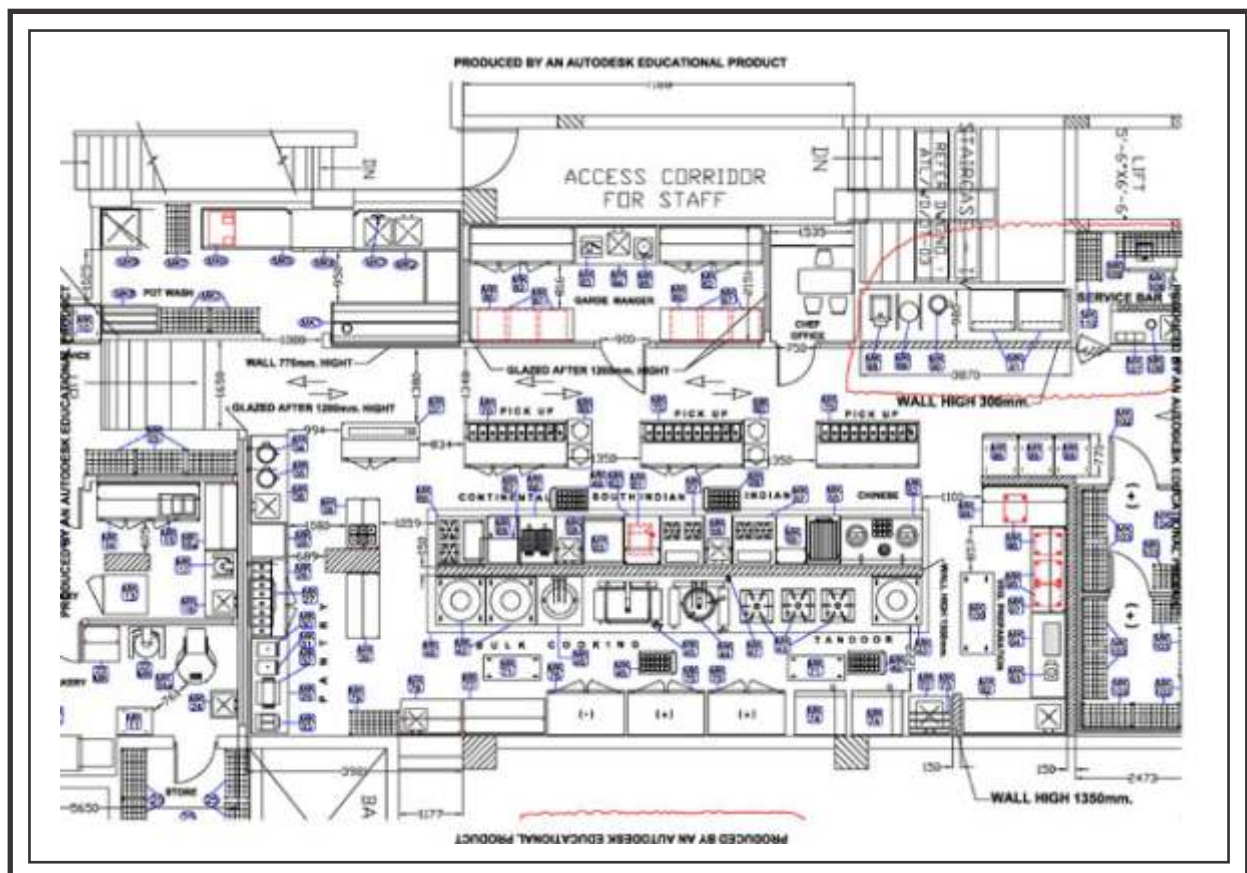

## Service Centers

Ahmedabad

Bengaluru

Chandigarh

Chennai

Coimbatore

Delhi

Goa

Hyderabad

Indore

Jaipur

kolkata

Lucknow

Mumbai

Pune

Vizag

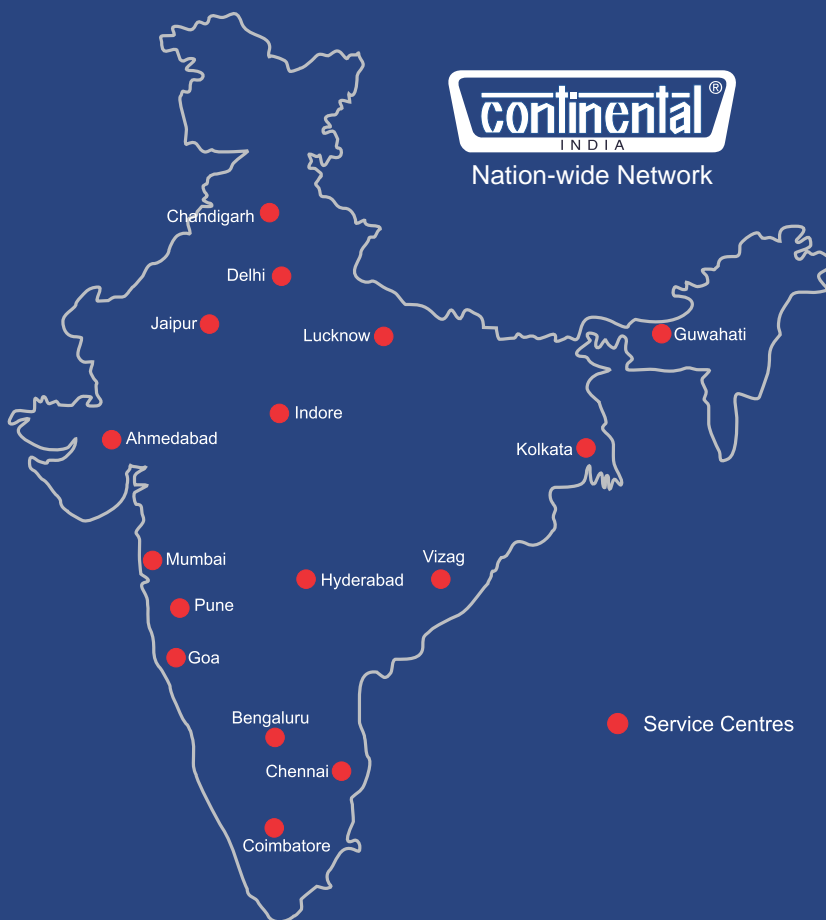

Nation-wide Network

## Continental Equipment India Pvt. Ltd.

Continental House

76-F, Udyog Vihar, Phase-IV, Gurgaon - 122 015, Haryana, India

Tel. : +91 124 492 0700, Fax : +91 124 401 4189

E-mail : [info@continentalindia.com](mailto:info@continentalindia.com)

### MUMBAI

109, Hindustan Kohinoor Complex, L.B.S.Marg, Vikroli (West),

Mumbai - 400 083

Tel : +91 22 2578 1260, 2578 1265, Fax : +91 22 4215 5357

E-mail : [west@continentalindia.com](mailto:west@continentalindia.com)

### BENGALURU

2/2, Bull Temple Road, Chamrajpet

Bengaluru - 560 018

Tel: +91 80 2667 3188, 2661 1627

Fax : +91 80 2661 1627

E-mail : [south@continentalindia.com](mailto:south@continentalindia.com)

### KOLKATA

42/14, Gate No. 4 Daga Colony, Dumdum Road,

Kolkata - 700 074

Tel : +91 33 2548 3437

E-mail : [east@continentalindia.com](mailto:east@continentalindia.com)

### HYDERABAD

Sapthagiri Colony, Plot No. 31/4, Reti Bowli Ring Road,

Mehdepatnam, Hyderabad - 700 074

Tel : +91 40 3257 9993

E-mail : [hyd@continentalindia.com](mailto:hyd@continentalindia.com)

[www.continentalindia.com](http://www.continentalindia.com)